

ITEM NO.	PART NUMBER	DESCRIPTION	Default/QTY.
1	102419	SEAL, INFLATABLE	1
2	102495	CABLE TIE, HEAVY DUTY	25
3	102500	GASKET, FLANGE SEAL	1
4	102502	HOSE CLAMP, INFLATION TUBE	1
5	102540	3/8 TUBE TEE DOT	1
6	102595	NUT, CLEVIS 1/2" DIA	6
7	102664	SLIDER, FLANGE	1
8	102665	SLIDER, COVER	1
9	103401	BUSHING FLANGED, 1/2" ID X 5/8" OD	1
10	103678	HINGE PIN THRUST WASHER	2
11	103688	WASHER, FLAT 14MM	7
12	103691	HINGE PIN D-RING	1
13	103735	SCREW, CS 1/4-20 X 1/2	6
14	103743	1/4 NPT X 3/8 TUBE STRAIGHT	1
15	103831	1/2-20 X 2 HEX BOLT	7
16	103859	1/2-20 NYLOK NUT	1
17	103870	PIN, CYLINDER	1

ITEM NO.	PART NUMBER	DESCRIPTION	Default/QTY.
18	103901	HOSE RETAINER	1
19	103948	CLEVIS PIN	6
20	103949	HAIR PIN	7
21	103950	HINGE PIN	1
22	103951	RETAINING RING, 1.5"	1
23	103952	HOSE BARB TO 1/4 NPT FEM.	1
24	103968	HINGE PIN CAP ROUND	1
25	103969	CUSTOM CASTLE NUT	1
26	103986	3 X 6 COMPOSITE CYLINDER	1
27	104014	1/4-20 x 1/2 Hex Bolt	2
28	104019	BUSHING, NYLON HINGE PIN	2
29	104210	COVER, CAST & MACHINED	1
30	104220	FLANGE, CAST & MACHINED	1

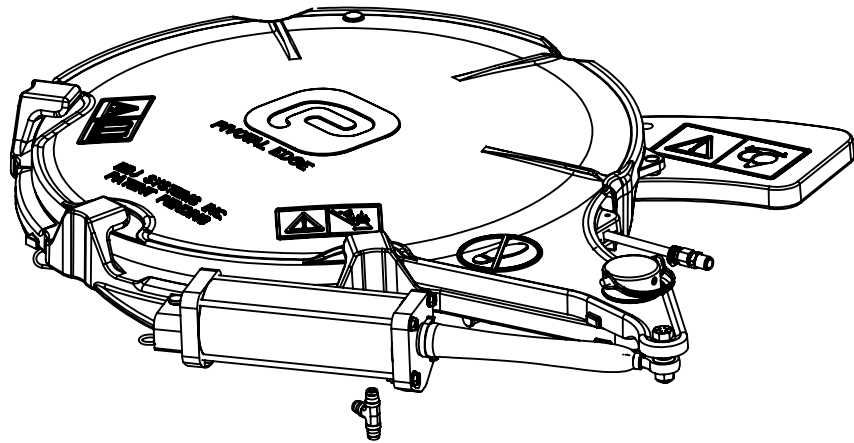

REVISIONS			
REV.	DESCRIPTION	DATE	APPROVED
A	CHANGED ITEM DESCRIPTIONS	9/20/2012	CJL
B	CHANGED P/N FROM 103843 MULTI TO 103843	9/26/2012	CJL
C	CHANGED TO NEW CYLINDER ASSEMBLY, FITTINGS, ADDED ZIP TIES AND CYLINDER SLEEVE, ADDED SHEET	6/27/2013	CJL
D	CHANGED TO NEW CYLINDER ASSEMBLY, FITTINGS, ADDED ZIP TIES	10/9/2013	CJL
E	CHANGED CUSTOM CYLINDER P/N, UPDATED TUBING, CHANGED FITTINGS ON SEAL	5/27/2014	CJL
F	CHANGED CYLINDER TO NEW DESIGN, CHANGED PIVOT BOLT, ADDED SLEEVE BEARING	9/19/2014	CJL
G	UPDATED WITH NEW FLANGE, CHANGED SLEEVE BEARING, REMOVED 2 WASHERS	1/16/2015	CJL
H	REMOVED SLEEVE BEARING AND PUT INTO 103672	4/3/2015	CJL
I	TOOK ALL PARTS FROM 103672 AND PUT INTO 103843, ELIMINATED PART NUMBER 103672, ADDED MOLDED BUSHINGS	10/27/2015	CJL

UNLESS OTHERWISE SPECIFIED:  
 DIMENSIONS IN INCHES  
 TOLERANCES:  
 LINEAR  
 X.XX ±.015  
 X.XXX ±.005  
 ANGULAR ±1°

NAME	DATE
DRAWN IS-CJL	10/26/15
ENG APPR. IS-CJL	10/26/15
MFG APPR.	

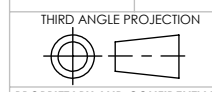

**PROPRIETARY AND CONFIDENTIAL**  
 THE INFORMATION CONTAINED IN THIS DRAWING IS THE SOLE PROPERTY OF PIVOTAL EDGE. ANY REPRODUCTION IN PART OR AS A WHOLE WITHOUT THE WRITTEN PERMISSION OF PIVOTAL EDGE IS PROHIBITED.  
 103843



TITLE:  
**BASE COVER ASSEMBLY**

SIZE	DWG. NO.	REV
<b>A</b>	103843	I

MASS LB SHEET 1 OF 4

**ALL PARTS EXPLODED VIEW**  
Item #2 not pictured

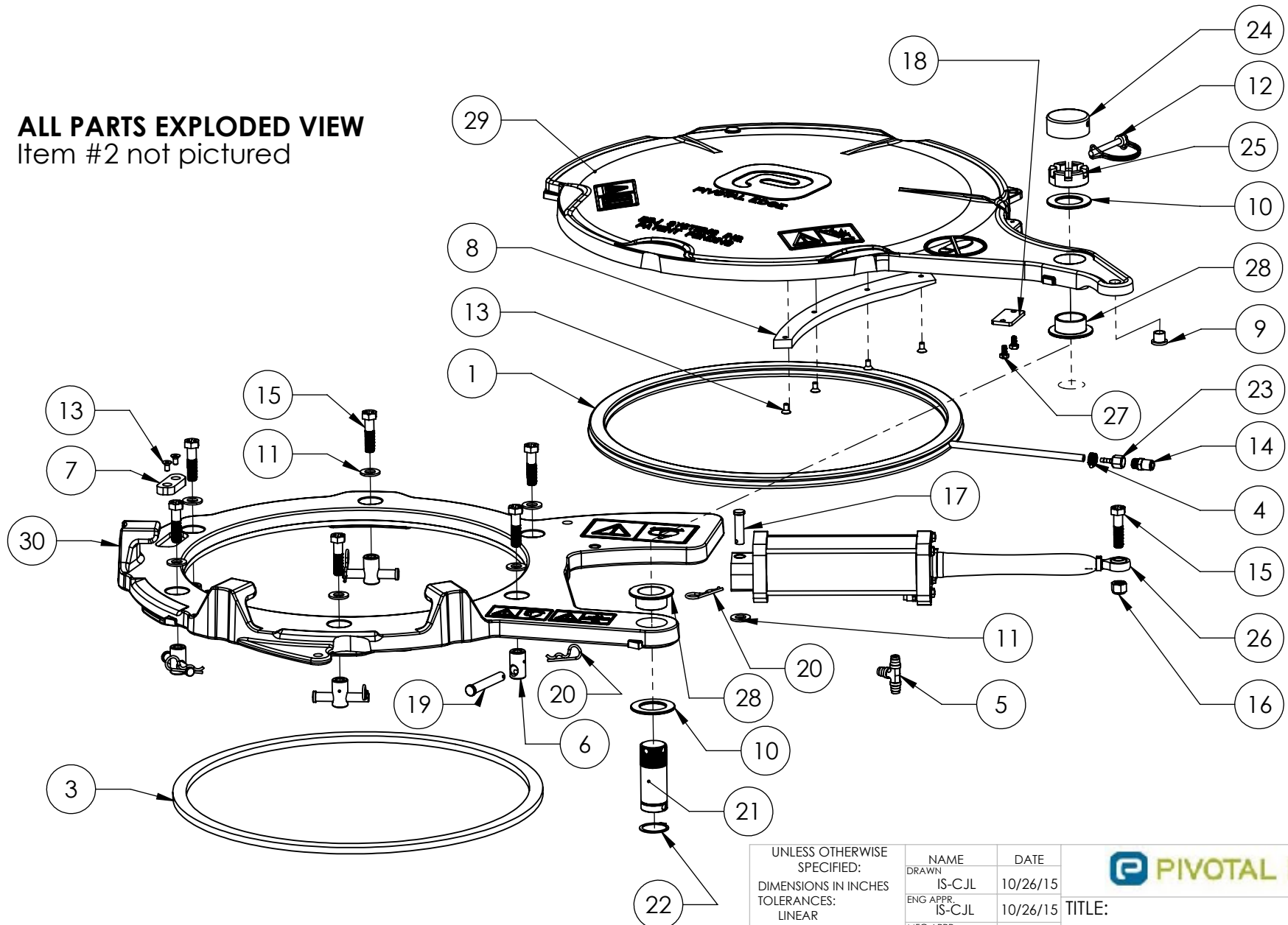

UNLESS OTHERWISE SPECIFIED:  
DIMENSIONS IN INCHES  
TOLERANCES:  
LINEAR  
X.XX ±.015  
X.XXX ±.005  
ANGULAR ±1°

NAME	DATE
DRAWN IS-CJL	10/26/15
ENG APPR. IS-CJL	10/26/15
MFG APPR.	
THIRD ANGLE PROJECTION	



TITLE: **BASE COVER ASSEMBLY**

MATERIAL  
  
FINISH

**PROPRIETARY AND CONFIDENTIAL**  
THE INFORMATION CONTAINED IN THIS DRAWING IS THE SOLE PROPERTY OF PIVOTAL EDGE. ANY REPRODUCTION IN PART OR AS A WHOLE WITHOUT THE WRITTEN PERMISSION OF PIVOTAL EDGE IS PROHIBITED.  
103843

SIZE	DWG. NO.	REV
<b>A</b>	103843	
MASS LB	SHEET 2 OF 4	

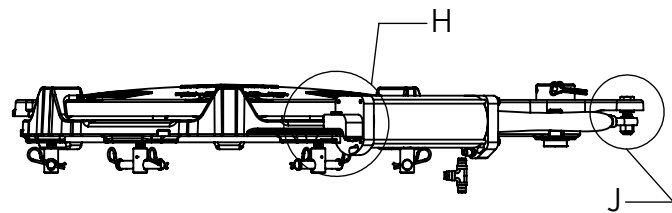
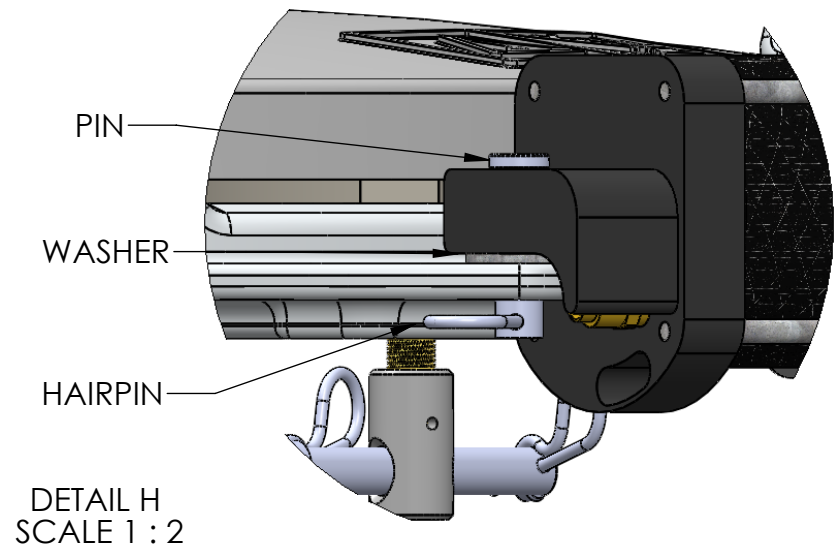
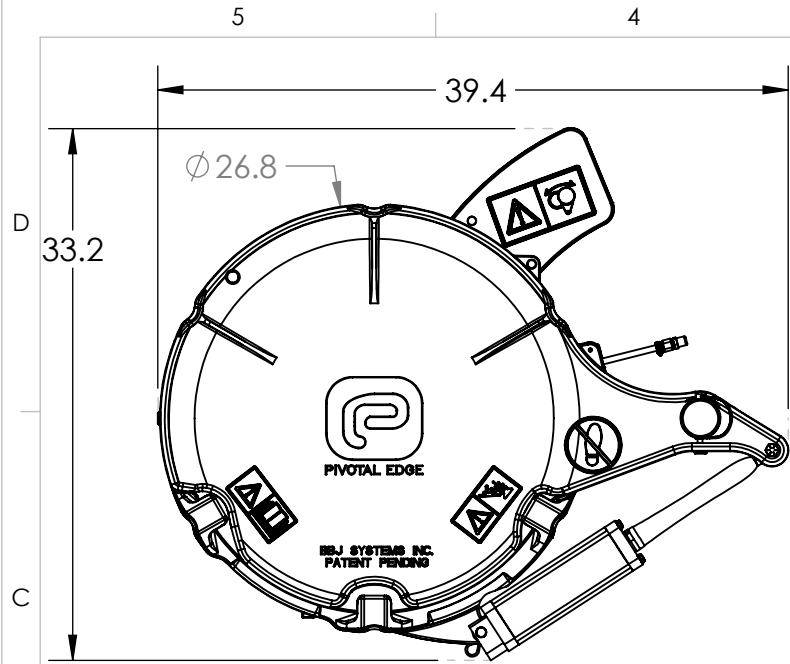

DETAIL J  
SCALE 1 : 3

UNLESS OTHERWISE SPECIFIED: DIMENSIONS IN INCHES TOLERANCES: LINEAR X.XX ±.015 X.XXX ±.005 ANGULAR ±1°	NAME IS-CJL	DATE 10/26/15		
	DRAWN IS-CJL	ENG APPR. IS-CJL		TITLE: BASE COVER ASSEMBLY
	MATERIAL	THIRD ANGLE PROJECTION 		SIZE <b>A</b>
	FINISH	PROPRIETARY AND CONFIDENTIAL <small>THE INFORMATION CONTAINED IN THIS DRAWING IS THE SOLE PROPERTY OF PIVOTAL EDGE. ANY REPRODUCTION IN PART OR AS A WHOLE WITHOUT THE WRITTEN PERMISSION OF APPLIED ENGINEERING IS PROHIBITED. 103843</small>	DWG. NO. 103843	REV 
	MASS LB		SHEET 3 OF 4	

5

4

3

2

1

# INSTALLATION EXPLODED VIEW

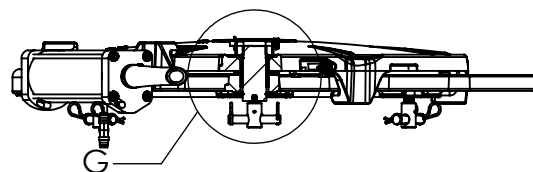
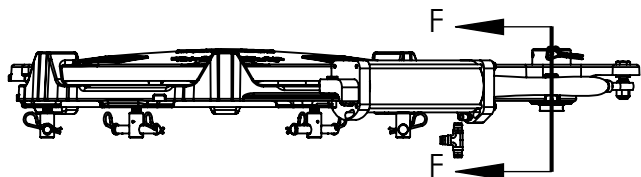
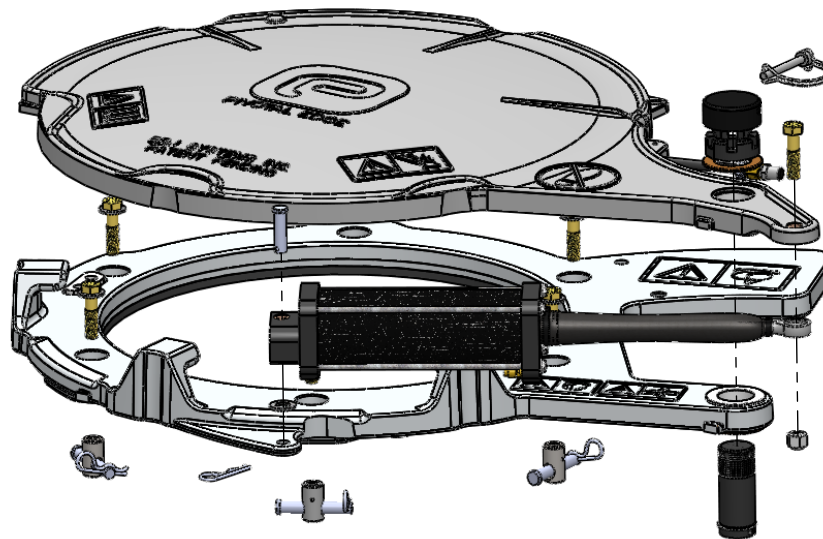
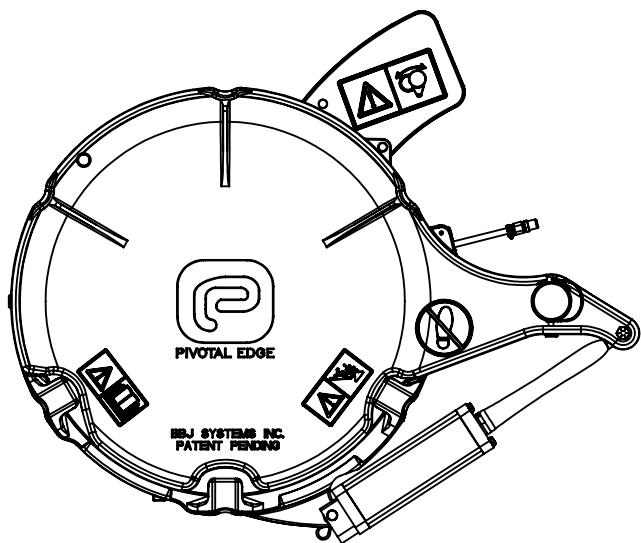

SECTION F-F

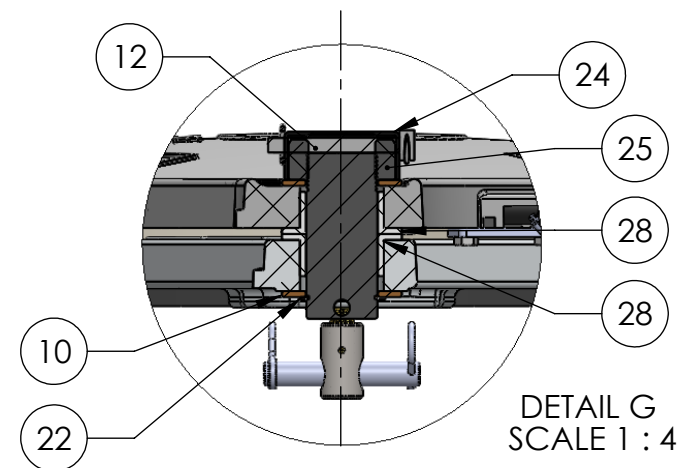

DETAIL G  
SCALE 1 : 4

UNLESS OTHERWISE SPECIFIED:  
DIMENSIONS IN INCHES  
TOLERANCES:  
LINEAR  
X.XX ±.015  
X.XXX ±.005  
ANGULAR ±1°

NAME	DATE
DRAWN IS-CJL	10/26/15
ENG APPR. IS-CJL	10/26/15
MFG APPR.	



TITLE:  
**BASE COVER ASSEMBLY**

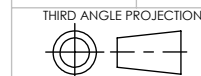

MATERIAL  
  
FINISH

PROPRIETARY AND CONFIDENTIAL  
THE INFORMATION CONTAINED IN THIS DRAWING IS THE SOLE PROPERTY OF PIVOTAL EDGE. ANY REPRODUCTION IN PART OR AS A WHOLE WITHOUT THE WRITTEN PERMISSION OF APPLIED ENGINEERING IS PROHIBITED.  
103843

SIZE	DWG. NO.	REV
<b>A</b>	103843	
MASS LB		SHEET 4 OF 4

5

4

3

2

1